

# LAVATORY CARRIER



Approval Date

520-07

CONCEALED ARM CARRIER WITH PIPE UPRIGHTS, WELDED BASE FEET, C.I. HEADER COUPLINGS, PIPE NIPPLES & HARDWARE.

FIXTURE

Manufacturer SLOAN

Name STANDARD No. SS-3005

Style LAVATORY SS-3105

SS-3805

Customer Approval

Wade Division / Tyler Pipe Assumes No Responsibility For Superseded or Voided Data

Job Location

Dimensional Data (Inches/mm) are Subject to Manufacturers Tolerance and Change Without Notice.

Job Name

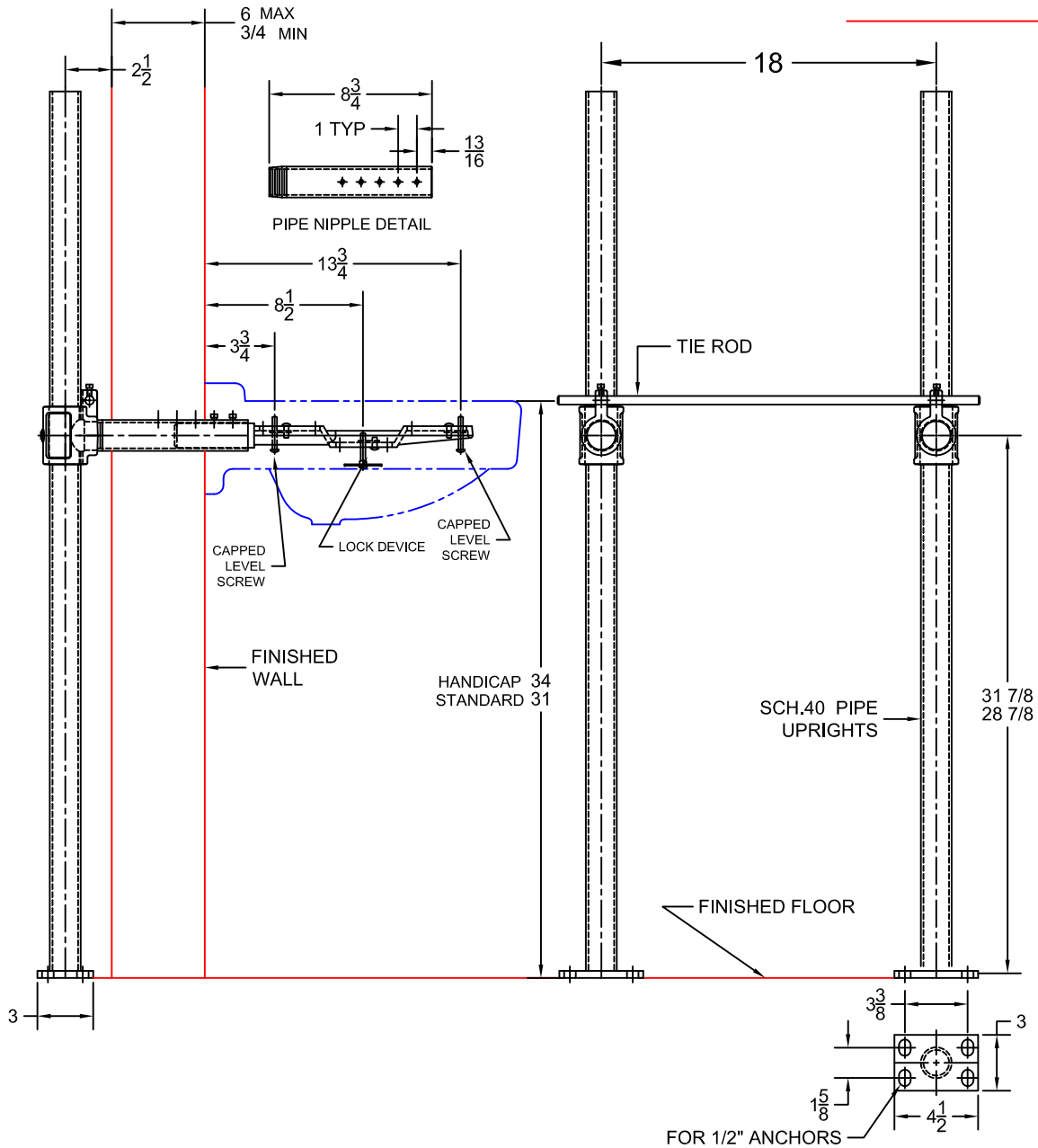

OPTIONS

Cat. No.	Type	Wt. Lbs.	Suffix	Description
520-07	SGL	36.0	M36	SQUARE UPRIGHTS

NOTE: CONTRACTOR MUST VERIFY DIMENSIONS WITH FIXTURE MANUFACTURER ROUGH-IN DATA TYLER PIPE / WADE DIVISION ACCEPTS NO RESPONSIBILITY FOR ANY INACCURACIES IN DRAWING

AutoCad.dwg